

ECS1501/02

Economy Cylinder Scale

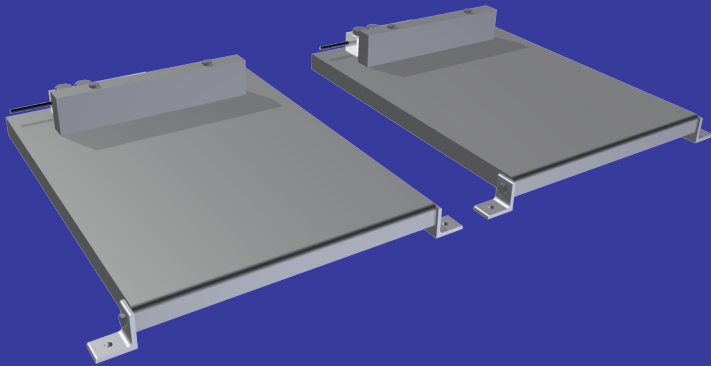

Features

- Reliable, simple design
- 4-20 mAdc output standard
- Stainless steel load cell
- PVC weigh plate for durability
- Low cost
- Unique push button zero
- Standard 2 year warranty

ECS1501/02

Eagle Microsystems now offers the ECS1501 (single) and ECS1502 (dual) cylinder scales. The scales are specifically designed for the water and wastewater treatment environments. The scale base is a solid PVC platform with a single stainless steel loadcell and hardware.

The included electronic readout is encased in a NEMA-4X fiberglass enclosure. All standard functions are accessed from the front panel without opening the enclosure. The standard 4-20mA analog output communicates with existing or future SCADA systems. See EI-1000/2000 datasheet for indicator details.

Your Source for Precision Process Solutions



ECS1501/02

Economy Cylinder Scale

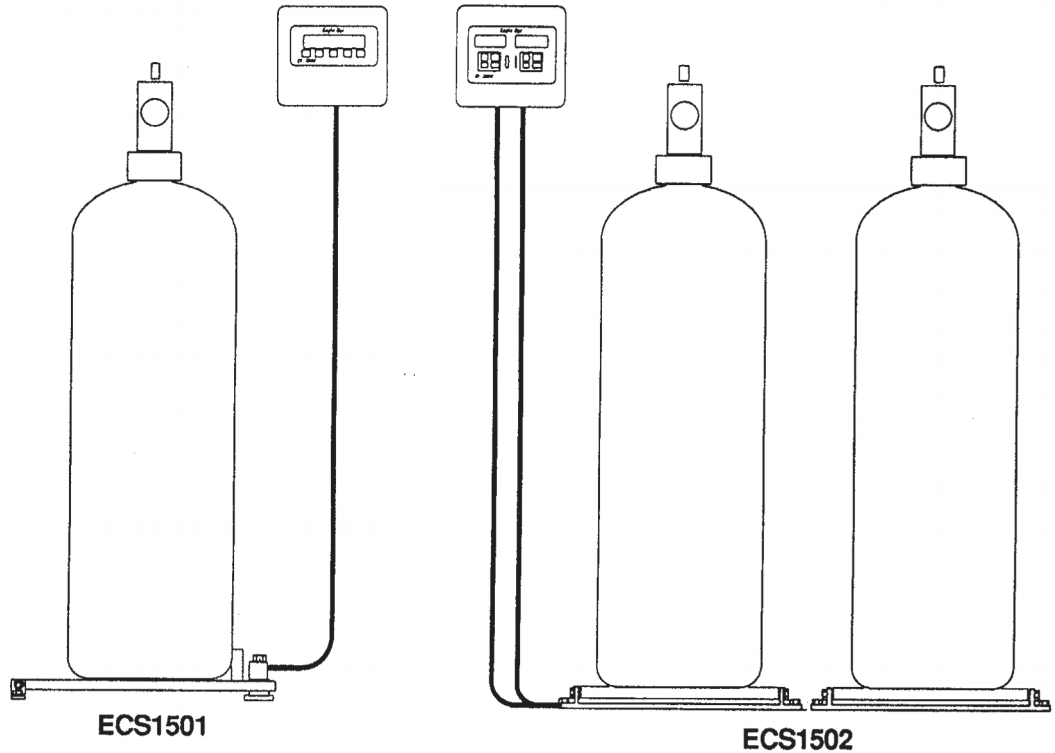

Specifications

Capacity	300lbs.
Cylinder Size	13" Diameter Max
Accuracy	± 1% Full Scale
Overload Capacity	150%
Temp. Comp. Range	30°-115°F
Hook Up Cable	15 ft.

Options

- RS485 Digital Interface
- RS232 Digital Interface
- Low Level Alarms
- Wall Mount Chain Brackets



www.EagleMicrosystems.com
Eagle Microsystems Inc. 366 Circle of Progress Pottstown, PA 19464
Telephone: 610.323.2250 800.780.8636 Fax 610.323.0114